

CHANNEL TRACK SINGLE END PULLEY

6" diameter sheave and bracket for returning the operating line to either a master carrier or the operator end of the track.

FAMILY INFORMATION

| PB_SingleEndPulley_Channel_Heavy_6.rfa | |
|--|-----------------------|
| Manufacturer | PBIM Generics |
| Revit Category | Specialty Equipment |
| PB Subcategory | PB-Track-Comp |
| LOD | 350 |
| Host | Unhosted / Workplane |
| Masterformat | 11 61 44 |
| Uniformat | E1070.10 |
| Omniclass | 23.40.50.14.24 |
| PB Version | 20.1.1.0 |
| PB ID Number | RFA-001-01060100-0004 |

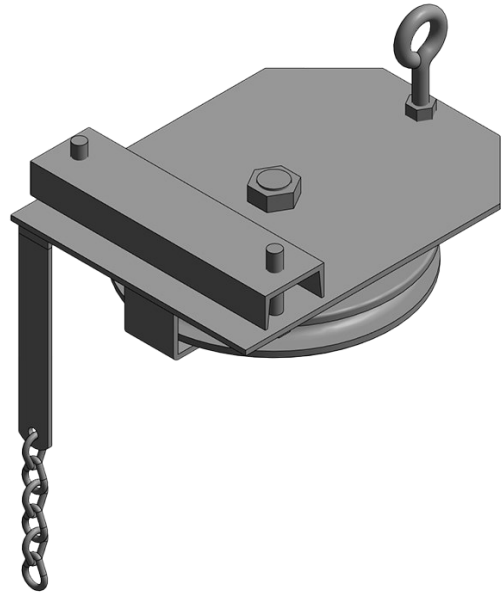

PRODUCT INFORMATION

| | |
|---------------|---------------|
| Manufacturer | PBIM Generics |
| Series | N/A |
| Product Model | N/A |
| Assembly Code | N/A |

FAMILY TYPES

| |
|----------------------|
| 1/2" Operating Line |
| 3/16" Operating Line |

PARAMETER INFORMATION

Parameter Flexing

The family may be flexed through type parameters and instance parameters. Parameters included in the following groups are intended to be user editable:

- Constraints
- Graphics
- Materials

Changing parameters in any other group risks “breaking” the family, and is not supported.

Parameter Descriptions

Type Parameters

| | |
|-----------------|---|
| Chain Length | Defines the length of the chain hanging from the pulley. Default is 6”. |
| Chain Material | Material used for the chain. Default is PB_Metal_Zinc. |
| Pulley Material | Material used for the pulley body. Default is PB_Metal_Black. |
| Sheave Material | Material used for the sheave. Default is PB_Plastic_Black. |

Instance Parameters

| | |
|------|---|
| None | No Instance Parameters are available for this family. |
|------|---|

USE INSTRUCTIONS

Insertion & Placement

The family may be inserted either through Insert -> Load Family, dragging into a project window, or via a content management system (as applicable).

IMPORTANT— The family is designed to insert the top of the pulley at the selected workplane.

Customization

The available customizations are the Chain, Pulley, and Sheave Materials as well as the Chain Length.

Other Parameters

As indicated on Page 2, while there are other parameters that are open to adjustment, **Performance BIM only supports user-editing parameters in the Constraints, Graphics, Materials and Finishes, and Identity Data groups. Any changes to other groups is done at the user's risk, and will not be supported by Performance BIM.**

Visibility Options

The visibility can be adjusted in the Visibility Graphics or Object Styles area under Specialty Equipment-> PB-Track-Comp